

## Information sheet #2

# Temporary restrictions on state-controlled roads due to unplanned events

(formerly road closures due to wet weather and flooding)

December 2022

This information sheet provides a brief overview of circumstances where temporary restrictions may be applied to state-controlled roads (SCRs) due to unplanned events. It is not exhaustive and is intended to help a range of Queensland state-controlled road users. Importantly, Transport and Main Roads is transitioning the way it describes road closures, due to wet weather and flooding, to encompass all circumstances, becoming 'a change to temporary restrictions, due to unplanned events'.

## Flooding and wet weather

Flooding and wet weather can cause extensive damage to SCRs, bridges and property. For the safety of all SCR users, and to protect assets, temporary restrictions on SCRs, such as closure, may be necessary while there is water on the SCR or, in some instances, after the water has receded, to allow for inspection.

Transport and Main Roads [Engineering Policy EP147 Road closure policy for wet weather and flooding](#) outlines the thresholds for placing a temporary restriction such as closure on an SCR such as when the depth of still water is 300 mm or more. In cases where the water is flowing, roads are closed at a lower depth, depending on the speed of flow – the faster the flow of water, the lower the depth for closure.

## Fire and smoke on state-controlled roads



Queensland's bushfire season generally occurs between late July and February.

Temporary restrictions such as closure can occur during 'burning off' operations or the fire season, to protect persons, property or the environment from actual or potential danger caused by fire. Queensland Fire and Emergency Services (QFES) collaborates with Transport and Main Roads and Queensland Police Service (QPS) about restrictions of SCRs during the bushfire season and fire / smoke hazardous situations.

Special care is required by Queensland SCR users when thick smoke is present, to minimise the likelihood of vehicles stopping within the smoke zone and posing a hazard to other vehicles. Queensland SCR users should comply with all signage.

More information is available on the [QFES website](#), the [QFES Rural Fire Service website](#) and the [QldTraffic website](#).

## Restricted Road Use Notices signage

Transport and Main Roads may install or erect Restricted Road Use Notices (RRUNs). These signs ensure the temporary restriction, such as a closure due to flooding, is clearly identified, and help protect SCRs from further damage.

The RRUNs are enforceable under Section 46(4) [Transport Infrastructure Act 1994](#) and a penalty may apply if a SCR road user drives past these signs without an exemption. Examples of the notices include:

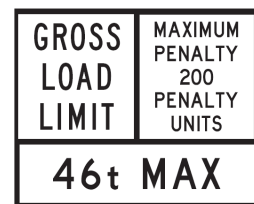
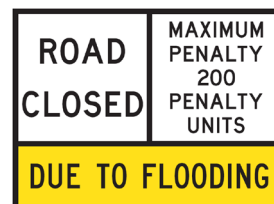

## Approval to drive past a Restricted Road Use Notice

Limited exemptions may exist to provide approval on a Queensland SCR to drive past a RRUN. They are subject to conditions and assessed on a case-by-case basis. They include:

**Single trip access (one-way trip only)** approvals are considered where there are extenuating circumstances (delivery of food, water or medical supplies).

**Local area access (multiple trip)** approvals are available for areas where SCRs are restricted for an extended period of time. Approval will apply to people who need to access their residence, property, business or essential services on a restricted SCR.

**Transport and Main Roads Transport Inspectors (single / multiple trips)** approvals are available in special circumstances where it is necessary for ensuring the safety of persons.

Applications to drive past the RRUN can be made through a local [Transport and Main Roads District / Regional office](#):

QPS also has this authority but applications should be made first to Transport and Main Roads wherever possible.

The following notice applies where local access approval has been granted for access to a restricted road. Permits are still valid, even if there is no 'Local Access Permits Excepted' sign present on the multi-message panel.

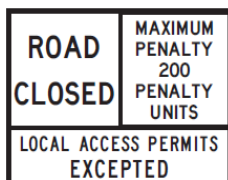

## Far North Queensland roads

During the wet season, a five-tonne load limit may apply to vehicles travelling on the Peninsula Developmental Road and Burke Developmental Road. This allows access to residences, properties and businesses, when it is safe to do so, without the need for an exemption.

## NO ENTRY signs

In circumstances that present a danger, hindrance or obstruction to traffic, or if other emergencies exist or have the potential to exist, an official traffic sign such as a NO ENTRY sign may be installed.

The signs following may be placed at the site of a temporary restriction. Unlike RRUNs, no approval will be granted for driving past a NO ENTRY sign. The white on black is a Light Emitting Diode (LED) sign.

A penalty may apply to any Queensland SCR user who drives past an official traffic sign such as a NO ENTRY Sign.



## Traveller information

For detailed, up-to-date information on restrictions, such as closures, and traffic incidents or hazards, visit the [QldTraffic website](#) or mobile app, or phone 13 19 40.

## Contact information

### After hours contact numbers

If contact cannot be made with the local Transport and Main Roads District / Regional office, please contact 13 19 40 for an operator.

### Policy, standards and information sheets

[TlManagement@tmr.qld.gov.au](mailto:TlManagement@tmr.qld.gov.au)  
Traffic Engineering, Technology & Systems  
Engineering & Technology

### Signage

[TrafficEngineering.Support@tmr.qld.gov.au](mailto:TrafficEngineering.Support@tmr.qld.gov.au)  
Traffic Engineering, Technology & Systems  
Engineering & Technology